

## Fireplace Capilla

### General data and commercial

Model: Capilla  
RS: A/1  
Weight: 60 Kg.  
Width: 450 mm.  
Height: 2910 mm.  
Long: 470 mm.

### Construction details and material

**Fireplace:** Set made of sheet steel polished 2mm thick.

**Tube:** Made of sheet steel polished 2mm thick.

**Grill:** Made of steel rods.

**Interior Section:** Made of plate steel polished 4mm thick. Between the inside section and the hood there is an air chamber.

**Painting:** The set is painted with glaze anticaloric-component, with colour matte black, with a thermal resistance of 950 ° C.

### TRANSPORT INFORMATION:

**CAGE:** 3100 x 580 x 650 mm. (Length x Height x Width)

**WEIGHT:** 110 Kg. TRUCK METERS: 3 m.

DAE Chimeneas reserves the right to make changes and / or changes in the products and specifications without notice.

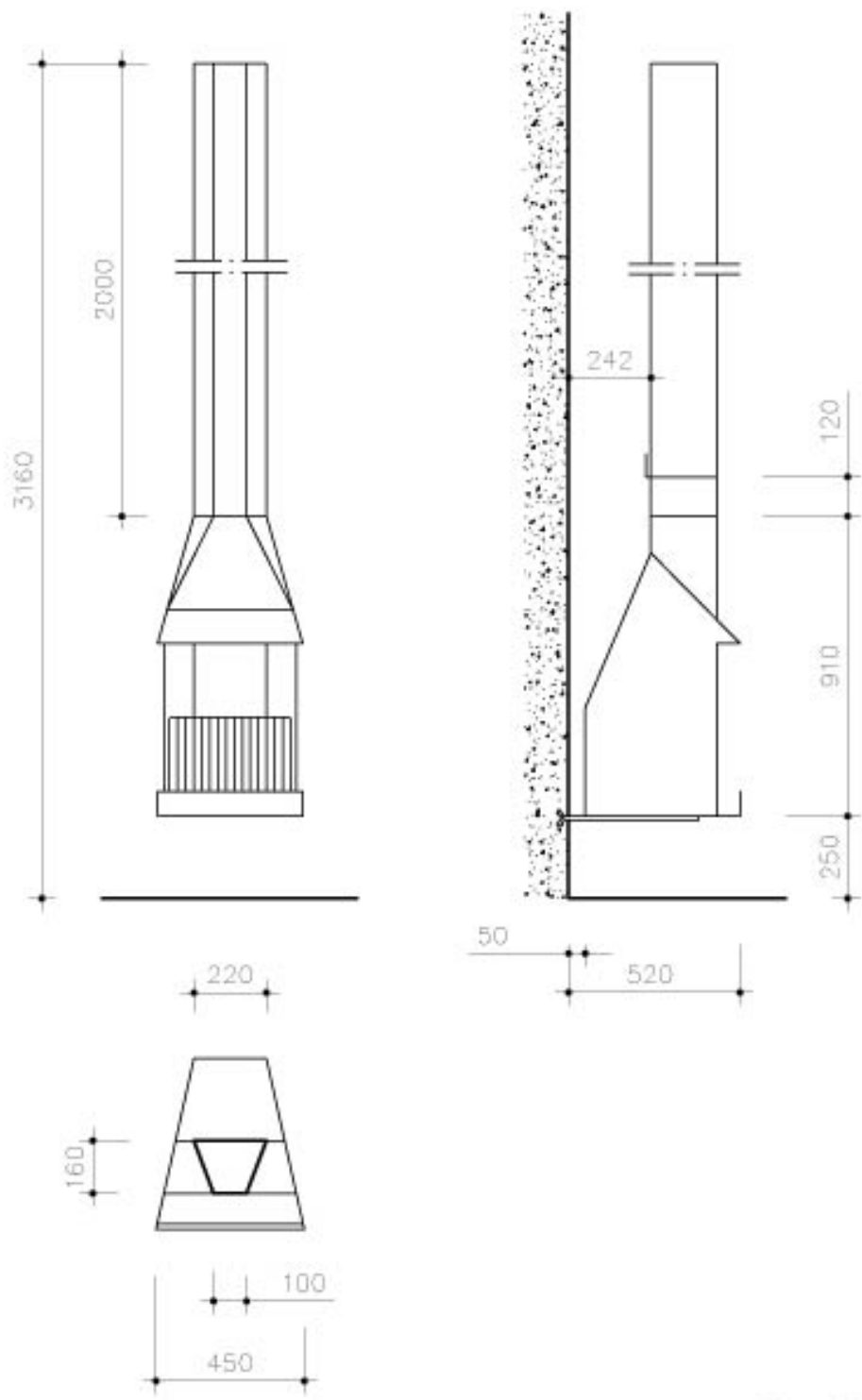

  
**DAE**  
 CHIMENEAS  
 Chimenea CAPILLA  
 Diseño: Corderch, J.A.  
 Correa, F.  
 Milá, A.